

# SETUP

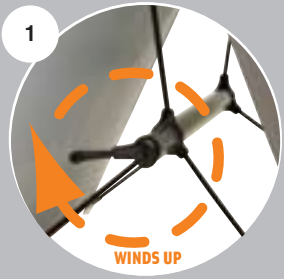

Holding the aluminum pole, wind the handle in a clock-wise direction.



As the legs extend, ensure that the banner is adequately lifted to allow the legs to open out.



Continue to wind only until the fabric becomes taut and firm.

# TAKE DOWN



To retract the banner, turn the handle in an anti-clockwise direction and allow the bottom legs to fully retract. Hug the top legs together to bring together.



**Please note:**

Do not continue to crank if the handle becomes stiff. As the legs retract, make sure the fabric doesn't get pinched in the mechanism.



Store in compact carry bag for easy portability

# WIND-UP BANNERS **NEW**



# CHANGING THE FABRIC



The plastic feet on the fabric are colour coded to each leg.  
4 x Blue  
2 x Red

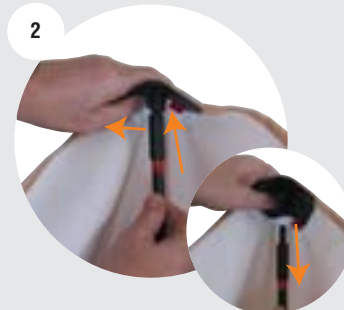

**Removing the fabric:**

With the legs partially extended, hold one of the colour coded plastic feet and a corresponding leg (e.g. with red band). Push the foot inward and pull up, unclipping the fabric from the leg. Repeat on the other feet until the fabric has been released.



**Attaching the fabric:**

Match the feet with corresponding coloured legs. With the legs partially extended, insert the flat side of the tip into the foot. Push down and click into place. Repeat until the fabric is attached.